

Concealed Hinge Boring: Pattern "A" 2.5mm

- Hole placement primarily designed for framed cabinetry.
- Boring consists of a 35mm diameter hole, 13.5mm deep with a 2.5mm tab dimension from the edge of the door.
- Insert holes are 8mm in diameter, 11.9mm deep, located 9.5mm from the center of the 35mm bore to the center of the 8mm insert bore.
- Specify with insert holes or cup only.
- Doors 8-13/16"– 42" long receive two bores.
- Doors 42-1/16"– 72" receive three bores.
- Doors 72-1/16" and longer receive four bores with center holes set 25" in from each end.
- Boring available on the following edge profiles only: B-2, CFP-2, L-034, L-059, L-149, L-281, L-297, L-382, L-803, L-1160, LC-2, LC-Inset, Machine Edge, PRS-2 and V-2.
- Concealed Hinge Boring is available on inset/prefit doors. Pattern "A" with or without insert holes, L-149, L-1160 and Machine Edge only.
- Pattern "A" accommodates the following hinge models for framed cabinetry:
 - Blum: Compact 33, 38C, 38N and 39C series
 - Grass: TEC series
 - Amerock: Matrix and 2811 series
 - Mepla: ACC162 (screw-in version)
 - Salice: "S" series
 - Ferrari: ET series and Compacta
- Custom boring locations available. Specify dimension from top or bottom edge of door to center of cup locations.

With insert holes

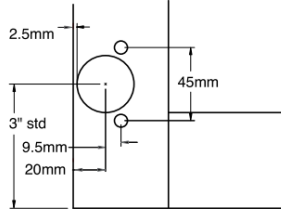

Cup Only

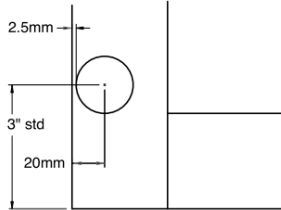

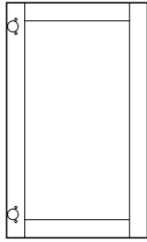

With insert holes

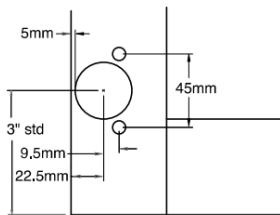

Cup Only

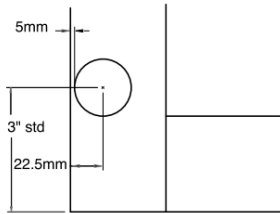

Concealed Hinge Boring: Pattern "B" 5mm

- Hole placement primarily designed for frameless cabinetry.
- Boring consists of a 35mm diameter hole, 13.5mm deep with a 5mm tab dimension from the edge of the door.
- Insert holes are 8mm in diameter, 11.9mm deep, located 9.5mm from the center of the 35mm bore to the center of the 8mm insert bore.
- Specify with insert holes or cup only.
- Doors 8-13/16"– 42" receive two bores.
- Doors 42-1/16"– 72" receive three bores with the third centered on the height of the door.
- Doors 72-1/16" and greater receive four bores with center holes set 25" in from each end.
- Boring available on the following edge profiles only: B-2, CFP-2, H-2, L-034, L-059, L-149, L-281, L-297, L-382, L-803, L-1160, LC-2, LC-Inset, Machine Edge, PRS-2 and V-2.
- Concealed Hinge Boring is available on inset/prefit doors with the following edge profiles: L-149, L-253, L-686, Machine Edge, L-947, L-967, L-304, L-996 and L-1160.
- Pattern "B" accommodates the following hinge models for frameless cabinetry:
 - Blum: 107, 120, 120+, 170, Diagonal 20, 30, 37, 45, Angle 25 and CLIP Top series
 - Grass: TEC, Nexis and Tiomos Series
 - Salice: 200 series (use 2mm mounting plate)
 - Ferrari: Anyway Clip series
- Custom boring locations available. Specify dimension from top or bottom edge of door to center of cup locations.